

All useful information to succeed in your printing business



THE GT-3 SERIES

# CookBook

*Maintenance*

v1.0



A maintenance guide for all GT-3 Series users

**brother**  
at your side





## > Mandatory Temperature & Humidity Requirements:

TEMPERATURE		HUMIDITY	
	MIN		MIN
	<b>18°</b>		<b>45</b>
	MAX		MAX
	<b>30°</b>		<b>85</b>

## OVERVIEW OF GT3 MAINTENANCE



There are several maintenance procedures that **must be performed** on a daily, weekly, or prompted basis to help keep your printer performing **properly**. This guide will list the maintenance items that must be performed.

*Please see the individual technical guide for each specific maintenance procedure for step by step instructions.*

## FIRST BASIC STEPS



### > HOW TO DO A NOZZLE TEST ?



Always place the **Platen** at level **A**

**Menu** > **Test Print** > **Nozzle Check CMYK** > **OK** to check colors on white paper sheet

**Menu** > **Test Print** > **Nozzle Check White** > **OK** to check whites on transparent or black sheet

If not all the nozzles are firing, start a **Head Cleaning**

### > HOW TO DO A PRINT HEAD CLEANING ?



Only a few nozzles missing, then **Head Cleaning** > **Normal Cleaning** ... and select **PH + OK**

If more then 10 nozzles, perform **Head Cleaning** > **Powerful Cleaning** ... and select **PH + OK**

Perform a new Nozzle Test to check the result and redo if not all nozzles are firing



## > Shaking White Ink

The White ink contains **titanium dioxide** which helps provide vibrancy. This will separate after being stationary for more than **eighteen hours**.

**Dull prints** will result if the ink is **not agitated before use**.

Shake the white ink cartridges side to side and tip end over end for **45 seconds**.

+ > No matter if you will have to do the **DCW** or **WA**, you **must** **SWI** **BEFORE !**

## > Daily Cleaning White



If the printer has **not** printed with **white** ink a **minimum of 15 T-shirts** the day before...

OR



If the printer has **not** printed with **white** ink within the last **eighteen hours**

> Then the **DCW** **must be performed** after the **SWI**

## > White Agitation



If the printer has printed with **white** ink a **minimum of 15 T-shirts** the day before...

OR



If the printer has printed with **white** ink within the last **eighteen hours...**

> Then the **WA** **could be performed** after the **SWI**

## > TIP

+ **NZC** & **PHC**

After performing the daily maintenance on the white ink, a **nozzle check** should be **printed**



## > WEEKLY MAINTENANCE PROCEDURE



White ink requires **weekly maintenance**. CMYK ink **does not** requires weekly maintenance. The white ink system requires a **weekly cleaning**.

The **LCD Display** will prompt you when the White Tube Cleaning should be performed. The prompt will appear **seven days** after the completion of the **previous White Tube Cleaning**.

### > White Tube Cleaning

Menu > Maintenance > White Tube Cleaning > All Whites > OK *and follow instructions on the display*

Select "All Whites" for usual maintenance. This will activate the retrieval solenoid for 4 minutes, to drain the white ink of the tubes back into the white ink cartridges.

After WTC, insert **White Filter cartridges** or **Capping cartridges** in the white ink lines.

## > CAPPING CARTRIDGES

If you intend to leave the printer idle for longer than the weekend, it is a good idea to put **Capping cartridges** instead of Filter cartridges in the white ink lines.

If you don't have those cartridges, use 2 or 4 **almost** empty white cartridges, they will keep the line sealed (no air) and prevent the maintenance solution to drip from the PH's. Don't forget to mark or label those cartridges to avoid confusion !

### > How to RESTART after White Tube Cleaning



Shaking **White Ink**

Before Loading the White ink !

Menu > Maintenance > Load White > All Whites > OK *and follow instructions on the display*



**NZC** & **PHC**

After performing the White ink loading, a **nozzle check** should be **printed**.



Please note then **1 week** after the **WTC** you will be prompted by the display to perform a new **WTC** automatically.

If you have **not** printed with white ink and if you still have maintenance solution in the machine, you can **dismiss** the message.



### > WEEKLY ADDITIONAL MAINTENANCE PROCEDURE



**Visual inspection** is important to keep your printer up and running.

Verify all the moving parts of the machine and also check for leakage of ink.

After you have done the **WTC**, take the opportunity to **clean** the **rubber Wiper Blades** to avoid the white ink to dry and stay on the Wiper. It will prevent dry particules of ink to block the nozzles during the next cleaning.

Also **clean all the caps** of the maintenance station (specially the rectangle lip) to remove again dry ink but also some fluff and lint of the T-shirts. They will allow the air to pass through the capping station and reduce the good suction of the pump.

### > WIPER BLADES CLEANING:

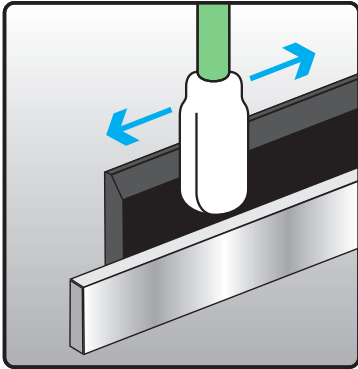

The wiper **cleans** the underside of the **print heads** to allow the **nozzles** to fire properly. The wiper is cleaned by passing across the **wiper cleaner**.

Once this cleaner is dirty or over saturated, the wiper edge can **no longer be cleaned** and therefore no longer clean the nozzle plates.

Apply **cleaning solution** to a swab and wipe across the **front** and **backside** of the 2 wiper **rubber blades**.

**Check** the wiper edge for any **tear** or separation from the metal base. If any exists, the wiper sub-assembly must be replaced by a new one.



SPARE PARTS NUMBER:

**SB3635001**

### > RUBBER CAPS CLEANING:



Once the wipers are clean, the **cap rubbers** must be cleaned with the **swabs** as well. The **rims** of the cap rubbers press against the bottom of the print heads, Nozzle Plates, to form a **seal** so air cannot dry the heads. If the rims of the caps have debris, dried or excessive ink, the ink will back away from the membrane and nozzles will **misfire**.

If this continues over time, the **print head** will dry and eventually become **defective**.

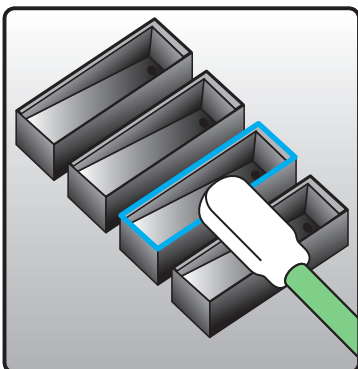

**Moisten** a swab as done for the wiper blade cleaning, and **swab the edges of the cap rubber**.

Use **one side** of a swab **per cap** so you do not **contaminate** one color to another.

Once all of the caps have been cleaned, **insert the new wiper cleaner**. The wiper blades should be in the **center**, between the two sets of cap rubbers.

**Power on** the printer. The printer will boot up as normal except it will **drain each cap**, one at a time, before it moves the carriage.

# STANDARD MAINTENANCE SCHEDULE



## > WHITE Maintenance Standard Procedure for GT3 Series

	Week	Mon	Tue	Wed	Thu	Fri	Sat	Sun
361 381 W	1	WTC ⊕ LW	DCW	DCW	DCW	DCW	-	-
	2	WTC ⊕ LW	DCW	DCW	DCW	DCW	-	-
	3	WTC ⊕ LW	DCW	DCW	DCW	DCW	-	-
	4	WTC ⊕ LW	DCW	DCW	DCW	DCW	-	-

White Tube Cleaning

Load White

Daily Cleaning White



Shaking White Ink

Everyday before operating !



Cleaning & Greasing

# MAINTENANCE with WHITE AGITATION SCHEDULE



> ONLY FOR USERS PRINTING A **MINIMUM** OF 15 PRINTS WITH WHITE INK ON BLACK OR DARK T-SHIRTS A DAY !!!



## > 5 working days a week example

Min. 15 white prints a day !

	Week	Mon	Tue	Wed	Thu	Fri	Sat	Sun
361 381 W	1	WTC ⊕ LW	WA	WA	WA	WA	-	-
	2	DCW	WA	WA	WA	WA	-	-
	3	WTC ⊕ LW	WA	WA	WA	WA	-	-
	4	DCW	WA	WA	WA	WA	-	-

## > 3 or 4 working days a week example

Min. 15 white prints a day !

	Week	Mon	Tue	Wed	Thu	Fri	WE
361 381 W	1	WTC ⊕ LW	WA		DCW	WA	-
	2		WTC ⊕ LW	WA	WA		-
	3	WTC ⊕ LW	WA	WA			-
	4			WTC ⊕ LW	WA	WA	-

White Tube Cleaning

Load White

Daily Cleaning White



Shaking White Ink

Everyday before operating !

White Agitation



## > MONTHLY MAINTENANCE PROCEDURE



**Monthly** Maintenance has to be performed on top of the **Daily & Weekly** Maintenance. The purpose is to keep the printer in the best status for printing without problems. Remember that it is better to spent 15 minutes every month than to be with machine down for several days !  
We recommend you to do the **cleaning** and **greasing of the CR shaft, cleaning CR rail** and a good **visual inspection** of the printer.



## CARRIAGE SHAFT CLEANING & GREASING

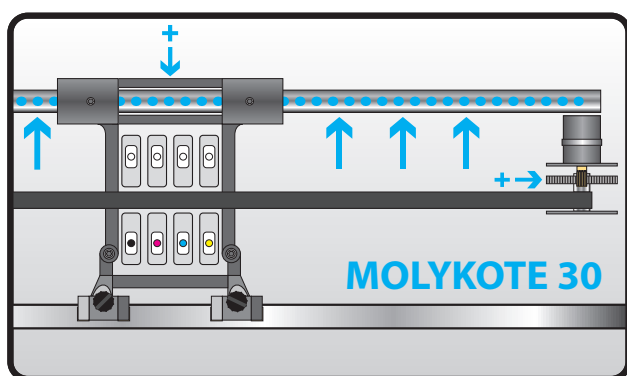

**Pour alcohol** (95% or higher) on a **cloth** and **clean the carriage shaft thoroughly**.

When clean, coat the shaft with **Molykote 30** white grease.

Don't forget to grease **between** the 2 bearings in the middle of the carriage.

Add also a little bit of **Molykote 30 grease** at the bronze **sprocket** of the **CR Motor**.



SPARE PARTS NUMBER:

**SB3229001**



*After **cleaning** & greasing the **Carriage Shaft**, please, perform a **CR Speed Adjustment** on the machine !*



## CARRIAGE RAIL CLEANING

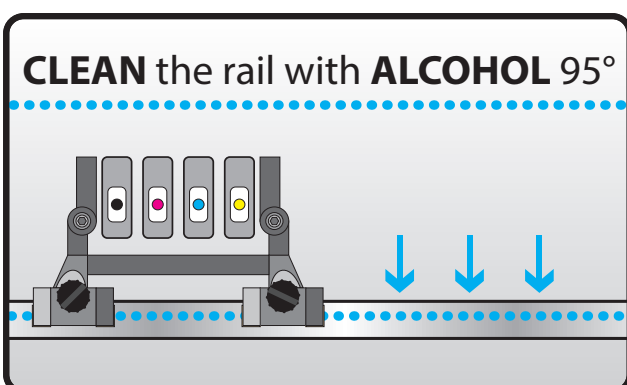

Unscrew the knob on the felt supports and remove them.

**Pour** a little **alcohol** (95% or higher) on a **cloth** and **clean the rail thoroughly**.

Remove and **replace the felts** on the bottom of the felt supports in accordance with the "**Maintenance Parts Exchange**".

Reattach both felt supports and tighten the knob screw.



## > MAINTENANCE PARTS EXCHANGE PROCEDURE:

The 2 **wiper cleaners**, the **fan filter**, the **flushing tray sponge** and **felt pads**, and the **carriage felt pads** need to be replaced in the **MPE** procedure.



The prompt to “**Exchange Maintenance Parts**” will occur after **EIGHTY** head cleanings (normal, powerful, or auto).

Normally after this amount of cleanings, the wiper cleaner will be **saturated** to the point where the wiper can **no longer be cleaned**.

When this happens, the nozzle plate will not be cleared and the **nozzles** may be **blocked** or the **firing** may be **misdirected**.

Menu > Maintenance > Maintenance Parts Exchange > OK *follow instructions and turn off printer*



*It is important that you **use this menu** and not another one to replace **MPE** parts because it will **reset** the internal counter to **zero**!*

## > WIPER CLEANER REPLACEMENT:

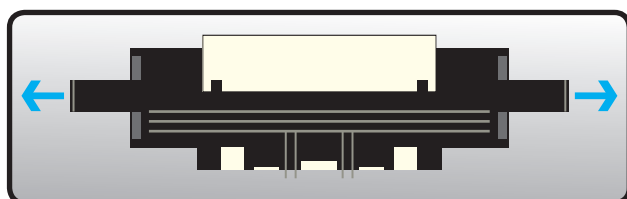

The **Wiper Cleaner** needs to be replaced **regularly** according to **MPE** or visual inspection.

**Clean the Print Head Caps and Wiper Blade before replacing the Wiper Cleaner !**



SPARE PARTS NUMBER: **SB3101001**

## > FAN FILTER REPLACEMENT:

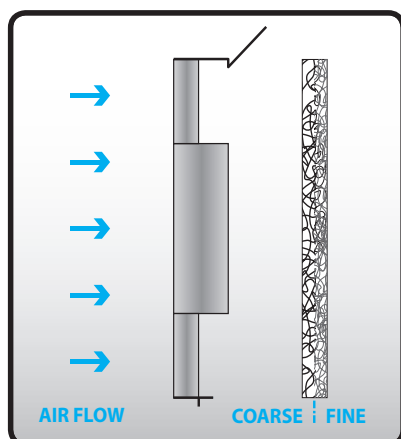

The fan filter collects the mist from the print head spray from the exhaust provided by the fan.

> Remember to place the new filter with the “**Coarse**” side inserted into the bracket.

> The air flow should enter the rougher side.



SPARE PARTS NUMBER: **SB3018001**



## > FLUSHING TRAY FELT & SPONGE REPLACEMENT:

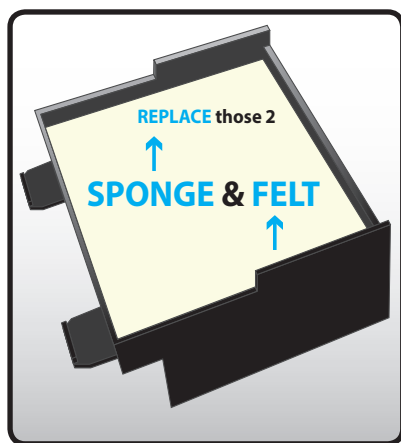

Insert the **felt** into the **flushing plate**.

Place the **sponge** on **top** of the felt.

Install back the assembled flushing plate into the machine.

**Check** that the **flushing plate** is well inserted and sitting in an **horizontal position** to **avoid touching** the **PH's** in movement !

+ SPARE PARTS NUMBER: **SB 3004001**

+ SPARE PARTS NUMBER: **SB 3005001**

## > CARRIAGE FELTS REPLACEMENT:

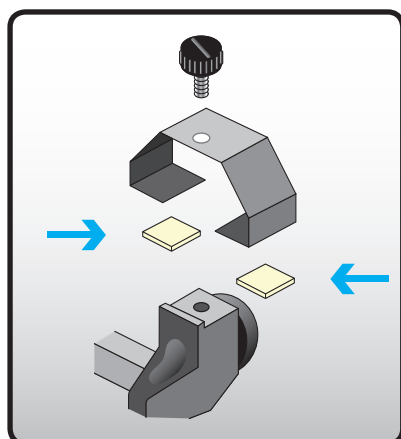

The **Carriage** contains **2 brackets** on the front edge that hold **4 felt pads** onto Velcro inserts.

The carriage assembly has **2 wheels** that ride along the front rail.

The pads keep the rail **clean** to help allow the carriage move unrestricted and smooth.

Be carefull **not to bend** the 2 brackets, it may end up with **errors** (i.e. 6107. 6108) and also, **do NOT** put **oil** on the **felts** !

+ SPARE PARTS NUMBER: **SB 2652101**



## CAP FELT REPLACEMENT

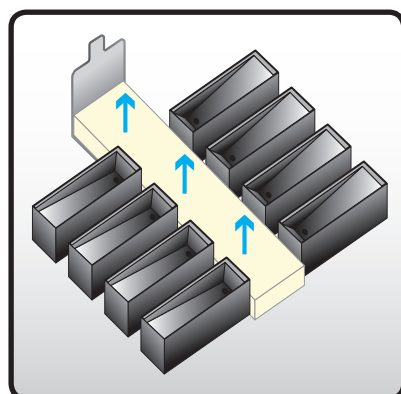

When needed, you can replace the **cap felt** sitting in between the two sets of four caps.

Just **lift** it and place a new one instead.

+ SPARE PARTS NUMBER: **SB 3006001**

# ENCODER STRIP CLEANING



Menu > Maintenance > CR Encoder Strip Cleaning > OK *follow instructions and turn off printer*

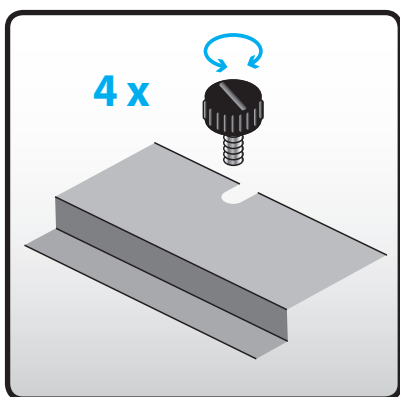

**Loosen** the four black thumb **screws** (do not remove) on the encoder cover, and remove the cover.

**Slide the carriage** to the **right side** of the machine.

Take the **encoder cleaning tool**, and apply isopropyl **alcohol** (95% or higher) to the **felt** portion.

**Gently slide** the tool across the **encoder strip**, remembering to move the carriage to get the other side of the strip.

Once done 2 or 3 times, remove the encoder tool **being very careful** not to damage the strip.

Attach the **cover back** and tighten the 4 thumb **screws**.

Turn the **machine on**.

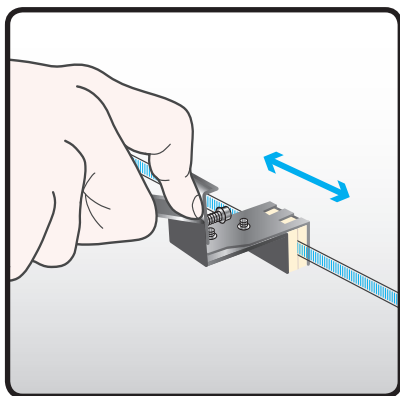
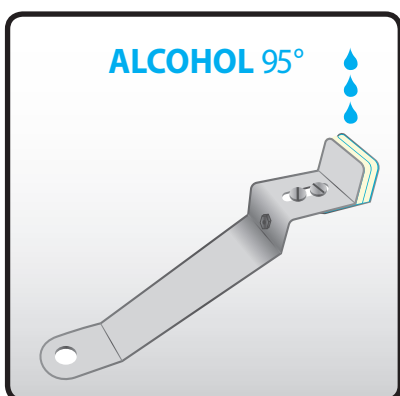

*After **cleaning** the **Encoder Strip**, perform a **CR Speed Adjustment** on the machine !*

# INK STORAGE RECOMMENDATIONS



Please keep in mind when **storing** the inks:

## TEMPERATURE

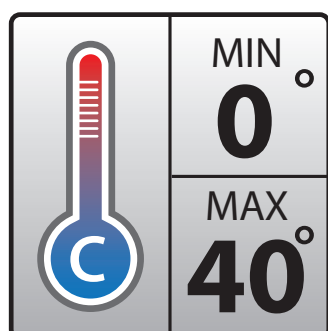

## SUNLIGHT





## PRINT HEAD NOZZLES CLEANING

Go to the menu: **Maintenance** > **Nozzle Cleaning**

- 1** With **Cleaning sticks** and cleaning fluid...  
> *clean the outside of the nozzle metal plate*
- 2** With **Clean Applicator** sticks and cleaning fluid...  
> *clean the surface of the small inner plate with nozzles, only in one direction!*

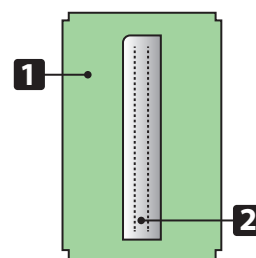

## NEW SUPPLY MAINTENANCE KITS AVAILABLE FOR GT3

### > FULL MAINTENANCE KIT:

2 x	Wiper Cleaner	SB3101001	4 x	CR Felts	SB2652101
10 x	Clean Stick	-	2 x	Glove	---
1 x	Flushing Sponge	SB3004001	10 x	Clean Applicator	---
1 x	Flushing Felt	SB3005001	10 x	Wash Liquid	SB5679001
1 x	Fan Filter	SB3018001			



SPARE PARTS NUMBER: **SB5677001**

### > FILTER FELT KIT:

10 x	Clean Stick	-	3 x	Fan Filter	SB3018001
3 x	Flushing Sponge	SB3004001	12 x	CR Felt	SB2652101
3 x	Flushing Felt	SB3005001			



SPARE PARTS NUMBER: **SB5678001**

GLOVES



## MAINTENANCE PARTS INCLUDED IN CARTRIDGES

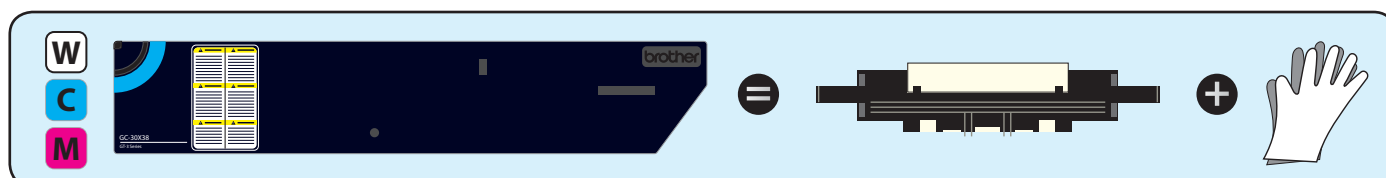

With each **White, Cyan & Magenta** cartridge, you will receive a **Wiper Cleaner** and a pair of plastic **gloves**.



## > CLEANING STICKS:



100 x **Clean Stick** for Caps and CLP plate cleaning (*short rectangular model*)

+ SPARE PARTS NUMBER: **N40000598**



100 x **Clean Applicator** for Nozzle plate cleaning (*long cylindrical model*)

+ SPARE PARTS NUMBER: **N40000599**

## > WASH LIQUID:

1 x 50cc **Wash Liquid** for cleaning Caps, Wiper blade, CLP plate and Nozzles

+ SPARE PARTS NUMBER: **SB5679001**



## > METAL GAUGE:

1 x Metal **Gauge** for good positioning of the Maintenance Station after cleaning

+ SPARE PARTS NUMBER: **SB3169001**

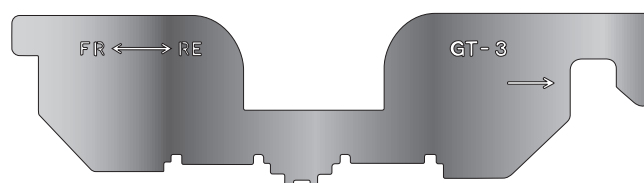





## IF YOU DON'T WANT TO USE WHITE INK

### > For less than 2 weeks:

You can leave White Ink in the white tube.

However you must do necessary maintenance for white ink.

### > For more than 2 weeks:

You have to use Maintenance Solution according to Instruction Manual.

When you stop to use white ink, please **clean** Caps, Nozzles and wiper blade of white Print Heads side.

*\* See A part of "6-2-6 Required Maintenance for the Long Storage" on Instruction Manual*

Perform a complete **White Tube Cleaning**.

On the end of this process the tubes will be filled with **maintenance solution**.

Put an almost empty white ink cartridge.

*\* Maintenance Solution will leak if you leave a Filter Cartridge!*

Every two weeks **refill tubes** with maintenance solution.

When white ink has to be used again, refill tubes with white ink using [Load White](#)



## 341 MODE

**> NEVER CHANGE MACHINE MODE TO 341 MODE WHEN WHITE HEADS ARE IN THE MACHINE!**

In 341 mode, the white heads **will not be purged automatically**.

This means that the wiper will do his job in dry condition.

**THIS WILL DAMAGE ALL WHITE PRINT HEADS !**

**> 341 Mode should only be used when white printheads are NOT installed.**  
**Maybe just at installation, when customer decides to use white ink much later**



## HOW TO CREATE A LOG FILE

Switch on the printer and insert a **USB stick**.

Go to the menu: [Maintenance](#) > [Log copy to USB](#)



Company Name:

Representative:

Email address:

Phone number:

<b>1. ENVIRONMENTAL CONDITIONS</b>	<b>P 1</b>
<b>2. OVERVIEW OF GT3 MAINTENANCE</b>	<b>P 1</b>
<b>3. FIRST BASIC STEPS</b>	<b>P 1</b>
<b>4. DAILY MAINTENANCE</b>	<b>P 2</b>
<b>5. WEEKLY MAINTENANCE</b>	<b>P 3</b>
<b>6. ADDITIONAL WEEKLY MAINTENANCE</b>	<b>P 4</b>
<b>7. STANDARD MAINTENANCE SCHEDULE</b>	<b>P 5</b>
<b>8. MAINTENANCE WITH WHITE AGITATION SCHEDULE</b>	<b>P 5</b>
<b>9. MONTHLY MAINTENANCE</b>	<b>P 6</b>
<b>10. CARRIAGE SHAFT CLEANING &amp; GREASING</b>	<b>P 6</b>
<b>11. CARRIAGE RAIL CLEANING</b>	<b>P 6</b>
<b>12. MAINTENANCE PARTS EXCHANGE</b>	<b>P 7 + P 8</b>
<b>13. CAP FELT REPLACEMENT</b>	<b>P 8</b>
<b>14. ENCODER STRIP CLEANING</b>	<b>P 9</b>
<b>15. INK STORAGE RECOMMENDATIONS</b>	<b>P 9</b>
<b>16. PRINT HEAD NOZZLES CLEANING</b>	<b>P 10</b>
<b>17. NEW SUPPLY MAINTENANCE KITS AVAILABLE FOR GT3</b>	<b>P 10</b>
<b>18. MAINTENANCE PARTS INCLUDED IN CARTRIDGES</b>	<b>P 10</b>
<b>19. OTHER USEFUL SPARE PARTS AVAILABLE</b>	<b>P 11</b>
<b>20. IF YOU DON'T WANT TO USE WHITE INK</b>	<b>P 12</b>
<b>21. 341 MODE</b>	<b>P 12</b>
<b>22. HOW TO CREATE A LOG FILE</b>	<b>P 12</b>
<b>23. CALENDAR FOR BROTHER GT3 SERIES PRINTERS MAINTENANCE</b>	









# > Calendar for Brother GT3 Series printers maintenance

MONTH	January	February	March	April	May	June	July	August	September	October	November	December	YEAR
													2015
													2016
													2017
													2018
													2019
													2020

DATES:	1	2	3	4	5	6	7	8	9	10	11	12	13	14	15	16	17	18	19	20	21	22	23	24	25	26	27	28	29	30	31
WEEKENDS:																															
Daily Cleaning White:																															
White Agitation:																															
White Tube Cleaning:																															
Load White:																															
Shaft Cleaning & Greas.:																															
Mainten. Parts Exch.:																															
Caps Cleaning:																															
Wiper Cleaning:																															
Rail Cleaning :																															
Encoder Cleaning:																															
Color Tube Cleaning:																															

Check the maintenance manual for full details !

## DAILY MAINTENANCE

- + Shaking White Ink
- If  or  White Agitation
- If not  or  Daily Cleaning White



## WEEKLY MAINTENANCE

- + White Tube Cleaning
- + Rubber Caps Cleaning
- + Wiper Blade Cleaning



## MONTHLY MAINTENANCE

- + CR Shaft Cleaning
- + CR Rail Cleaning
- + Visual Checking

+ Maintenance Parts Exchange when prompted !

## > Calendar for Brother GT3 Series printers maintenance

MONTH		YEAR	
January	April	July	October
February	May	August	November
March	June	September	December
		2015	2018
		2016	2019
		2017	2020

[illegible]

## DAILY MAINTENANCE

### + Shaking White Ink

**White Agitation**

**If not 15 or 18H** **Daily Cleaning White**

## WEEKLY MAINTENANCE

## + White Tube Cleaning

### **Rubber Caps Cleaning**

**Wiper Blade Cleaning**

## MONTHLY MAINTENANCE

**CR Shaft Cleaning**

**CR Rail Cleaning**

### + Visual Checking

**⊕ Maintenance Parts Exchange when prompted!**

***Check the maintenance manual for full details !***